

*Thank you for your interest in Boulder Ridge.  
We invite you to tour our private community  
in this most unique foothills setting.*





elcome to Boulder Ridge, an extraordinary lifestyle  
in a unique foothills setting.

Here, every day begins with a panoramic view of the Valley. Where private hiking trails are a crisp morning walk from your hillside home. You'll find a waterfall cascading behind a refreshing pool and spa. And where you can enjoy a tennis match under the lights.

Ask a resident about Boulder Ridge. You'll learn it's the little things they appreciate. Like cool ridge breezes. The aroma of barbeques coming from private picnic areas. Canopied mail boxes. A clubhouse with a full range of social activities, and separate recreation center. A well-equipped fitness center. On-site storage for recreational vehicles. A library with inviting reading area. And being just minutes from shopping, entertainment and business. All in a private, gated community with after-hours card-key access.



*So enjoy Boulder Ridge, a little at a time.  
Because easy living isn't always this easy to find.*



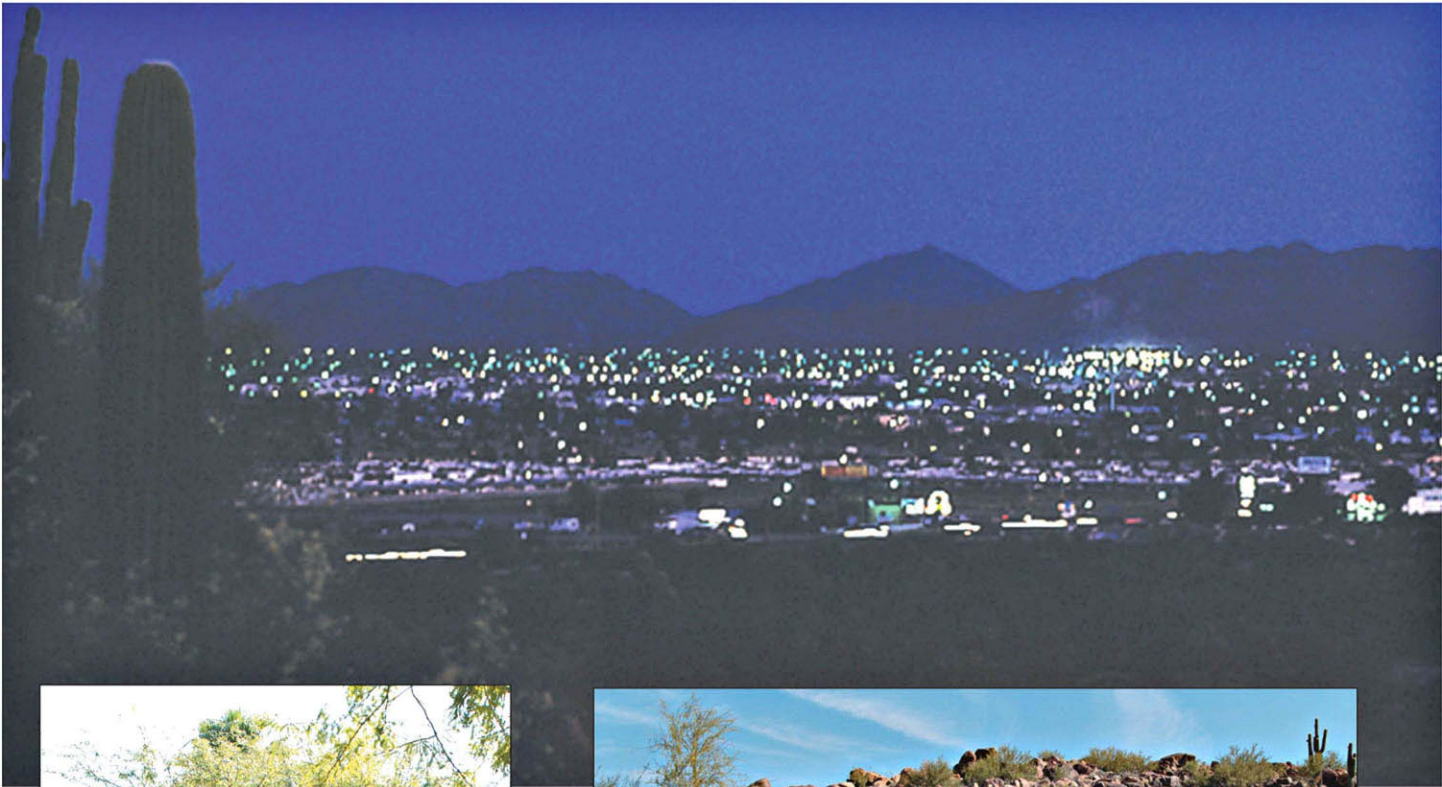



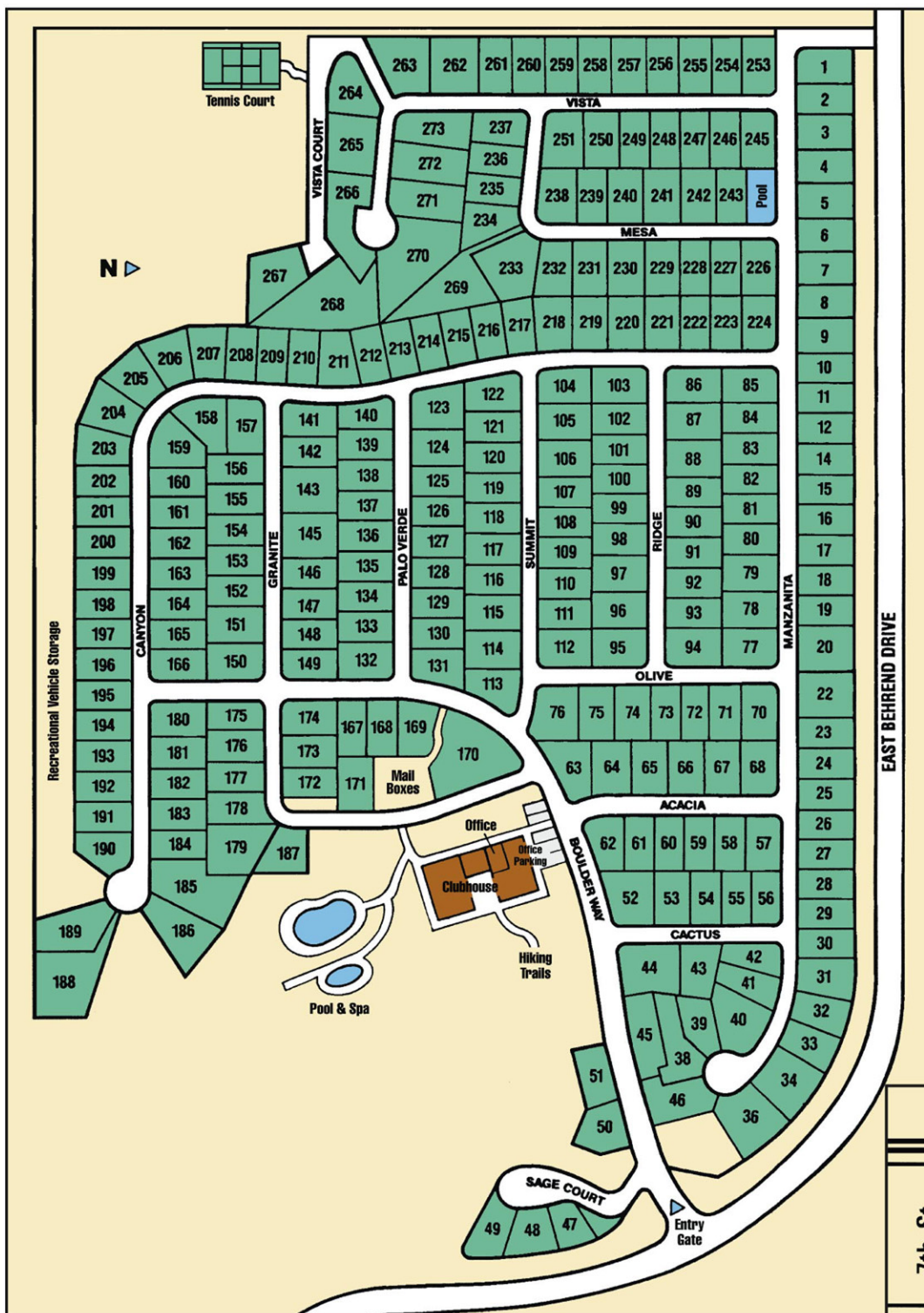

### *Boulder Ridge features:*

- Expansive clubhouse with recreation center, library and full range of social activities
- 2 sparkling pools and heated spas
- Hiking trails
- On-site storage for recreational vehicles
- Lighted tennis
- Gated, card-key entrance

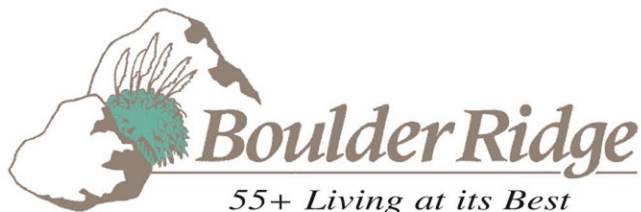
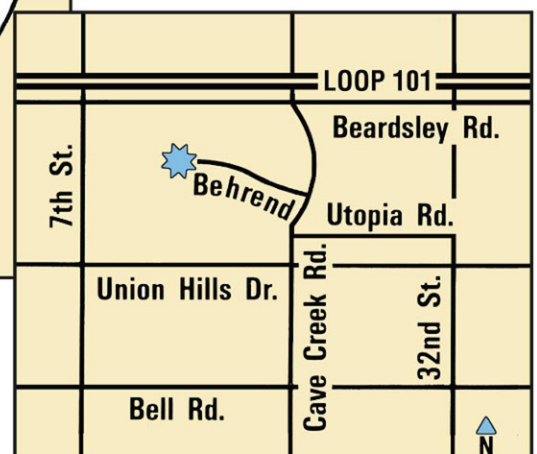

2233 E. Behrend Drive, Phoenix, Arizona 85024

(602) 569-1777 • Fax (602) 569-9557 • [www.boulder-ridge.com](http://www.boulder-ridge.com)

E-mail: [office@boulder-ridge.com](mailto:office@boulder-ridge.com)